

PR51 SERIES PRESSURE REGULATOR

PR51 series stainless steel pressure regulator has double stage diaphragm pressure reducing structure, constant outlet pressure, suitable for purified gas, standard gas, corrosive gas etc.

Design features:

- * Body with six port design
- * Double stage pressure reducing structure
- * Metal to metal diaphragm seal
- * Body inlet and outlet port: 1/4"NPT Female
- * Easy to clean structure
- * Filter mesh inside
- * Panel mount or wall mount
- * Outlet with needle valve or diaphragm valve for option

TYPICAL APPLICATIONS:

Laboratory, Gas Chromatograph, gas laser, gas manifold system, petroleum chemistry, and test equipment



Specifications:

Maximum input pressure: 2200, 3000psi

Output pressure: 0-25, 0-50, 0-100, 0-250, 0-500psi

Proof pressure: 1.5 times of maximum rated pressure

Working temperature: -40 + 165 deg F (-40 +74 deg C)

Inboard leakage: 2×10^{-8} atm cc/sec He, at 1500psi input pressure

Outboard leakage: 2×10^{-8} atm cc/sec He, at 1000psi input pressure

Flow capacity: Cv = 0.06

Material:

Body: SS 316L

Cover: SS 316L

Diaphragm: SS 316L

Filter mesh: SS 316L (10um)

Seat: PCTFE, PTFE

Spring: SS 316L

Poppet: SS 316L

Pressure gauge (wetted part) SS 316L

Net weight: 1.83 kgs

FLOW DATA

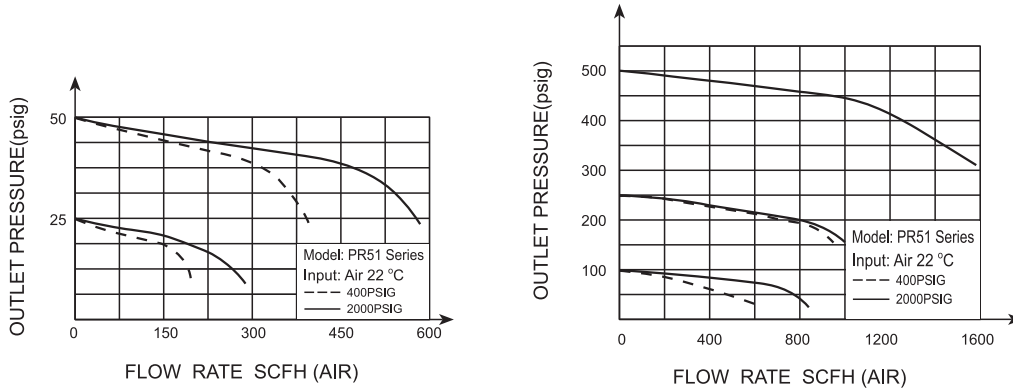

DIMENSIONS

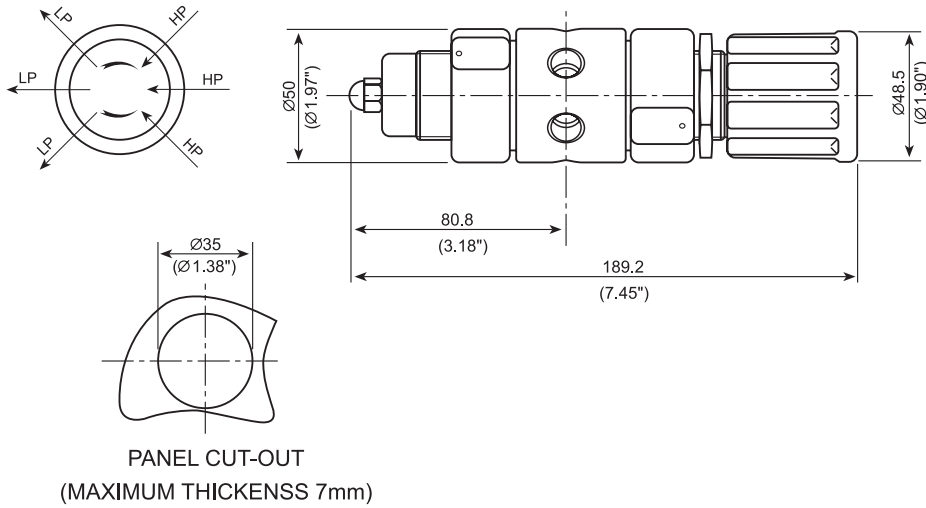

ORDERING INFORMATION

Series	SEAT	Input pressure	output pressure	Pressure gauge	Inlet port	Oulet port	Option
PR51	K:PCTFE V:Vespel	D:3000psig E:2200psig (15 MPa)	F:0~500psig G:0~250psig I:0~100psig K:0~50psig L:0~25psig Q:30"Hg Vac-30psig S:30"Hg Vac-100psig T:30"Hg Vac-200psig	M: gauge(Mpa) P: gauge(psi/bar) N: no gauge	02F:1/4"NPT(F) 02M:1/4"NPT(M) 23:CGA330 24:CGA350 27:CGA580 28:CGA660 30:CGA590 52:G5/8"-RH(F) 63:W21.8-14RH(F) 52:W21.8-14LH(F)	02F:1/4"NPT(F) 02M:1/4"NPT(M) 01T:1/8" Ferrule fitting 02T:1/4" Ferrule fitting 03T:3/8" Ferrule fitting 6T:6mm Ferrule fitting 8T:8mm Ferrule fitting	P: Panel mount S: Safety valve N: Needle valve D:Diaphragm valve